

What's NEW at ...



M850-MPD

MultiPower DC Meter

Main Features:

The M850-MPD MultiPower is a complete DC measuring, digital, universal metering system in a standard 96 x 96 mm DIN case. This multifunction power meter is suitable for DC applications ranging from 0-800V, DC (0-10A or 0-50mV shunt operated DC amps). This easy-to-read meter measures, calculates and displays main electrical parameters on your DC system quickly and easily.

- Complete single phase digital universal metering system. Covers a majority of applications without any modifications.
- Measures a standard range of 9 different parameters. Easy to use and easy to program from the front panel.
- Data is stored in non-volatile EEPROM memory. In power loss conditions, the data is retained.
- Four, easy to access, front control buttons are used for scrolling up or down through the parameters.
- Unique blue LED display is designed to be read in a variety of conditions, including bright sunlight over a very wide viewing angle. There are 8 levels of user-adjustable brightness.
- RS485 option and pulsed output are plug-in options that can be ordered with the MultiPower meter or retrofitted when required.
- Plug-in option of RS485 (Modbus protocol). Enables remote reading of up to 32 MultiPowers.
- Pulsed output via a plug-in relay option can be assigned to W.h and A.h.



PARAMETERS MEASURED and DISPLAYED

DC Amps	DC Energy (Watt Hours)	Max Amp Demand
DC Volts	Amp Demand	Max Power Demand
DC Power (Watts)	Power Demand	A.h (Ampere Hours)

PLUG-IN OPTIONS

Versatile plug-in units for RS485 (Modbus protocol) and pulsed output options can be purchased with the MultiPower meter or can be retrofitted at a later time. The RS485 enables remote reading of up to 32 MultiPower units on a 2-wire bus using Modbus protocol. The RS485 option is compatible with PC, PLC, RTU, Data loggers and Scada programs.

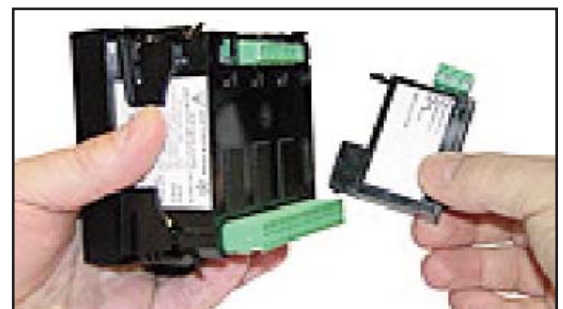

The pulsed output can be assigned to W.h and A.h.

M850-MPD MultiPower DC Meter



PC&S products are manufactured under a total quality system that provides total engineering integrity. Products have been engineered to satisfy specifications, performance, reliability and life cycle to exacting standards.

PC&S strives to meet customer requirements and exceed expectations. We do this through monitoring and measuring our process and product, customer satisfaction, internal auditing, analysis of production data, continual improvement including corrective and preventative action. Our quality management systems are certified in accordance with ISO 9001:2000 standards.

General Specifications

Rated Un	800V,DC
Un Overload	1000V,DC max.
V Burden	0.5VA
Rated In	0-10A,DC or 0-50mV,DC (via shunt)
I Overload	10 x In for 1 second
I Burden	0.5VA per phase
Auxiliary Voltage	100 to 440V,AC @ 46/65Hz, 100 to 420V,DC / 19-69V,DC (optional)
Auxiliary Burden	<10VA
User-Adjustable Display	8 brightness levels
	Digits: 3 lines 9999; Update time: 1 second
Approvals	UL Pending, CE

Wiring and Connection Diagrams

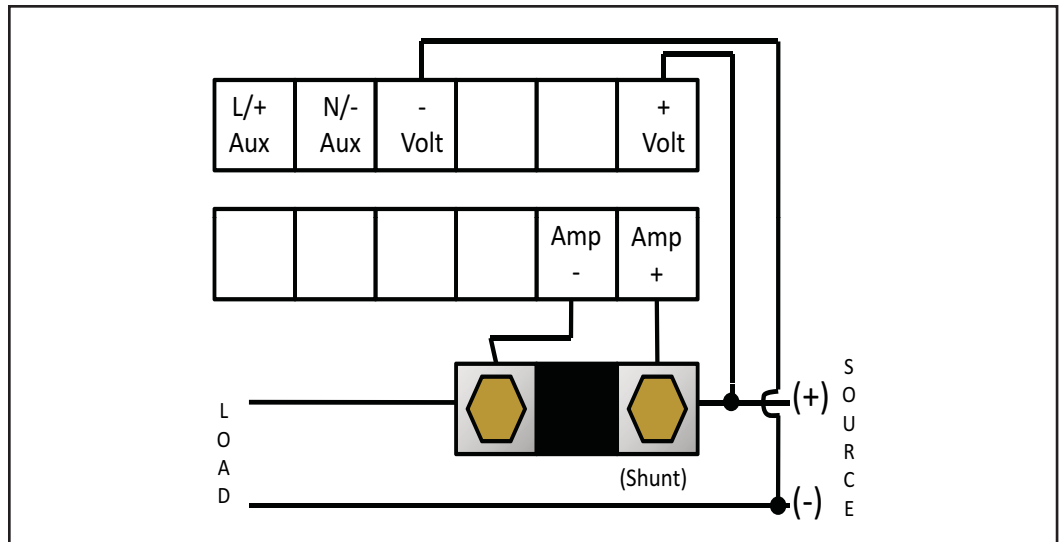
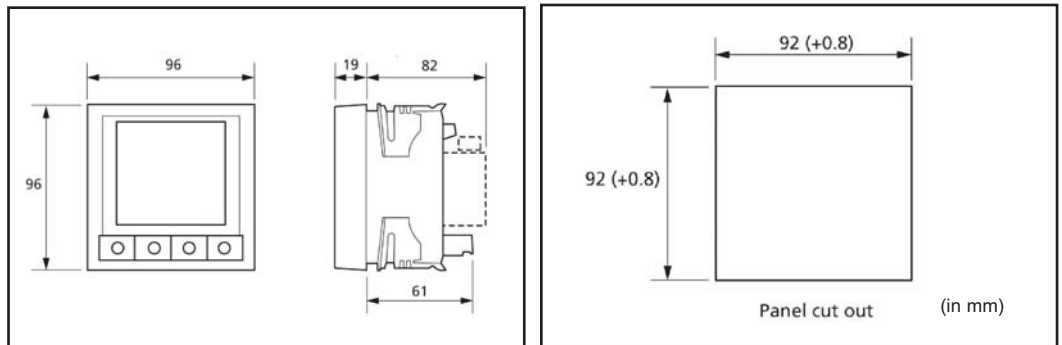

PANEL COMPONENTS & SYSTEMS, INC.
MAIN OFFICE: Tel.: (973) 448-9400 Fax: (973) 448-1674
 149 Main Street, Stanhope, NJ 07874

Your Local PC&S Distributor:

Additional Offices:

South East:
 South Central:
 Canada:

Charlotte, NC
 Tulsa, OK
 Edmonton, AB

Phone: (704) 535-3357
 Phone: (862) 258-6974
 Phone: (877) 962-0557

multitek

1 800 523-9194 ● www.pc-s.com