



DC Ammeter Shunts

STD Accuracy $\pm 0.25\%$

TYPE F: 100 through 600 Amperes



TYPE F: 50 mV

Catalog Number	AMP	A	B	C	D	E
F-100-50	100	4.50	1	0.50	3.50	3/8-16 \times 3/4
F-150-50	150	4.50	1	0.50	3.50	3/8-16 \times 3/4
F-200-50	200	4.50	1	0.50	3.50	3/8-16 \times 3/4
F-250-50	250	5.37	1.37	0.75	4.00	1/2-13 \times 1
F-300-50	300	5.37	1.37	0.75	4.00	1/2-13 \times 1
F-400-50	400	5.37	1.37	0.75	4.00	1/2-13 \times 1
F-500-50	500	5.50	1.50	1	4.00	1/2-13 \times 1 1/4
F-600-50	600	5.50	1.50	1	4.00	1/2-13 \times 1 1/4

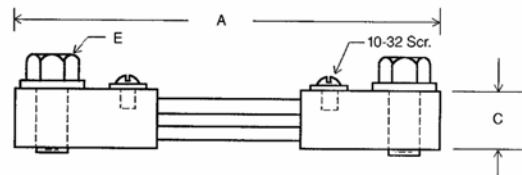
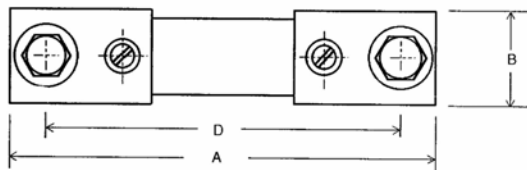

Tolerances $\pm .015$ for the hole diameters. Other tolerances $\pm .030$ unless specified. Dimensions subject to change without notice.

Panel Components & Systems, Inc.

Tel.: 1 (800) 523-9194 ■ www.pc-s.com